

EXCELLENT CYCLING ABILITY



GL-12150

ADVANCED TECHNOLOGY

GELLED VALVE REGULATED
LEAD ACID BATTERY (GVR)
FOR CYCLING APPLICATIONS

12V 150AH @ 20 HR RATE to 1.75VPC

12V 162AH @ 100 HR RATE to 1.75VPC

LONG DURATION

FOR
TELECOMMUNICATION
SOLAR / PHOTOVOLTAIC
WIND GENERATION
MARINE
APPLICATIONS

Innovative Features

- ◆ Deep cycle battery designed, GEL electrolyte with highly porous glass micro-fiber separator;
- ◆ Exceptional energy storage capacity combined with long life - BCI Classification;
- ◆ Thick positive plate design for maximum service float life - 12 years design life @ 20°C(68°F);
- ◆ Thickness positive plate plus optimized plate alloy to anti-corrosion;
- ◆ Maintenance-free (no topping up) during the whole service life due to EverExceed GEL technology ;
- ◆ Proprietary Fixed Orifice Plate Pasting technology applying active materials on both sides of the grid for consistent cell-to-cell performance, higher capacity and uniform grid protection;
- ◆ Flame-arresting one-way pressure-relief vent for safe and long life;
- ◆ Electrolyte in solid gel form will not stratify no equalization charge required;
- ◆ Sulfuric acid thixotropic gel, gel powder from Europe leading supplier to ensure the unique performance of gel battery;
- ◆ Increased durability and deep cycle ability for heavy duty applications;
- ◆ Fully tank formed grid Lead Calcium Tin plate ensures voltage matching between cells;
- ◆ Shelf life up to 2 years at 20°C (68°F), very low gassing due to internal gas recombination;
- ◆ Can be used in any orientation. Upright, side or end mounting recommended;
- ◆ Unique performance against high temperature;
- ◆ UL Recognized component;
- ◆ Spill-proof and leak-proof.

12 VOLTS - 150 AMPERE HOUR @ 20 HOUR RATE

AH Capacity to 1.75VPC @ 20°C (68°F)

| End Point Volts/Cell | 1.5hr | 2hr | 3hr | 4hr | 5hr | 8hr | 10hr | 12hr | 20hr | 24hr | 100hr |
|-------------------------|-------|-----|-----|-----|-----|-----|------|------|------|------|-------|
| 1.75 | 97.8 | 104 | 112 | 118 | 121 | 133 | 137 | 141 | 150 | 154 | 162 |

Gellyte Range VRLA

EverExceed®
power your applications

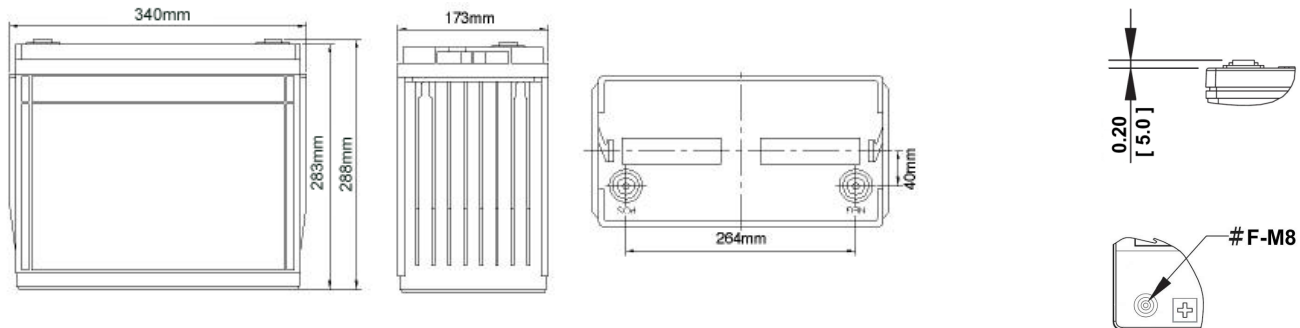

Length: 340mm Width: 173mm Height: 288mm

| Electrical Specifications | | | | | |
|---------------------------|------------------|----------------|-------------|-----------------------|-------------------------------|
| Cells Per Unit | Voltage Per Unit | Weight | Electrolyte | Short Circuit Current | Internal Resistance Milliohms |
| 6 | 12.84 | 90.2lbs 41.0kg | SG = 1.300 | 3825 Amps | 2.7 |

| | |
|--|---|
| Capacity | 12V 150AH @ 20 HR RATE to 1.75VPC 12V 162AH @ 100 HR RATE to 1.75VPC |
| Applicable Operating Temperature Range | -40°C (-40°F) to +70°C (158°F). |
| Ideal Operating Temperature Range | +20°C (+68°F) to +32°C (90°F). |
| Floating Charging Voltage | 13.5 to 13.8 VDC/unit Average at 20°C (77°F). |
| Recommended Maximum Charging Current Limit | 30.0 Amperes (0.20 C20 Amperes) |
| Equalization and Cycle Service Charging Voltage | 14.1 to 14.4 VDC/unit Average at 20°C (77°F). |
| Maximum AC Ripple (Charger) | 0.5% RMS or 1.5% P-P of float charge voltage recommended for best results. Maximum voltage allowed = 1.4% RMS (4% P-P). Maximum current allowed = 0.75 amperes RMS (C/20) to 1.75VPC. |
| Self Discharge | EverExceed Gellyte Range batteries may be stored for up to 24 months at 20°C (68°F) and then a freshening charge is required. For higher temperatures the time interval will be shorter. |
| Accessories | Inter unit connectors racks and cabinet systems are available. |
| Terminal: Inserted | Threaded copper alloy insert terminal. |
| Terminal Hardware Initial Torque: Inserted Terminal | 11 N-m |

| Constant Power Discharging Ratings - Watts Per Cell @ 20°C (68°F) | | | | | | | | | | | |
|---|-------|------|------|------|------|------|------|------|------|------|-------|
| End Point Volts/Cell | 1.5hr | 2hr | 3hr | 4hr | 5hr | 8hr | 10hr | 12hr | 20hr | 24hr | 100hr |
| 1.85 | 115 | 92.7 | 67.4 | 53.8 | 44.8 | 30.3 | 25.3 | 21.6 | 14.1 | 12.0 | 3.16 |
| 1.80 | 123 | 97.7 | 70.0 | 55.4 | 46.2 | 31.5 | 26.3 | 22.4 | 14.3 | 12.3 | 3.35 |
| 1.75 | 125 | 99.1 | 72.0 | 57.3 | 46.9 | 32.3 | 26.8 | 22.8 | 14.7 | 12.8 | 3.47 |

| Constant Current Discharging Ratings - Amperes Per Cell @ 20°C (68°F) | | | | | | | | | | | |
|---|-------|------|------|------|------|------|------|------|------|------|-------|
| End Point Volts/Cell | 1.5hr | 2hr | 3hr | 4hr | 5hr | 8hr | 10hr | 12hr | 20hr | 24hr | 100hr |
| 1.85 | 59.9 | 48.0 | 34.4 | 27.1 | 22.6 | 15.1 | 12.4 | 10.5 | 6.85 | 5.90 | 1.54 |
| 1.80 | 64.1 | 50.7 | 36.2 | 28.5 | 23.7 | 15.9 | 13.4 | 11.3 | 7.24 | 6.22 | 1.59 |
| 1.75 | 65.3 | 52.0 | 37.3 | 29.6 | 24.2 | 16.5 | 13.7 | 11.7 | 7.50 | 6.45 | 1.62 |

Note: Batteries to be mounted with 0.39 in (1.00 cm) spacing minimum and free air ventilation.
Specifications subject to change without notification.